

PST-TW400

Air-Cooled Mig Welding Torch

Rating: 320A CO₂, 270A mixed gas, EN60974-7 @ 60% duty cycle. 0.8 to 1.2mm wires

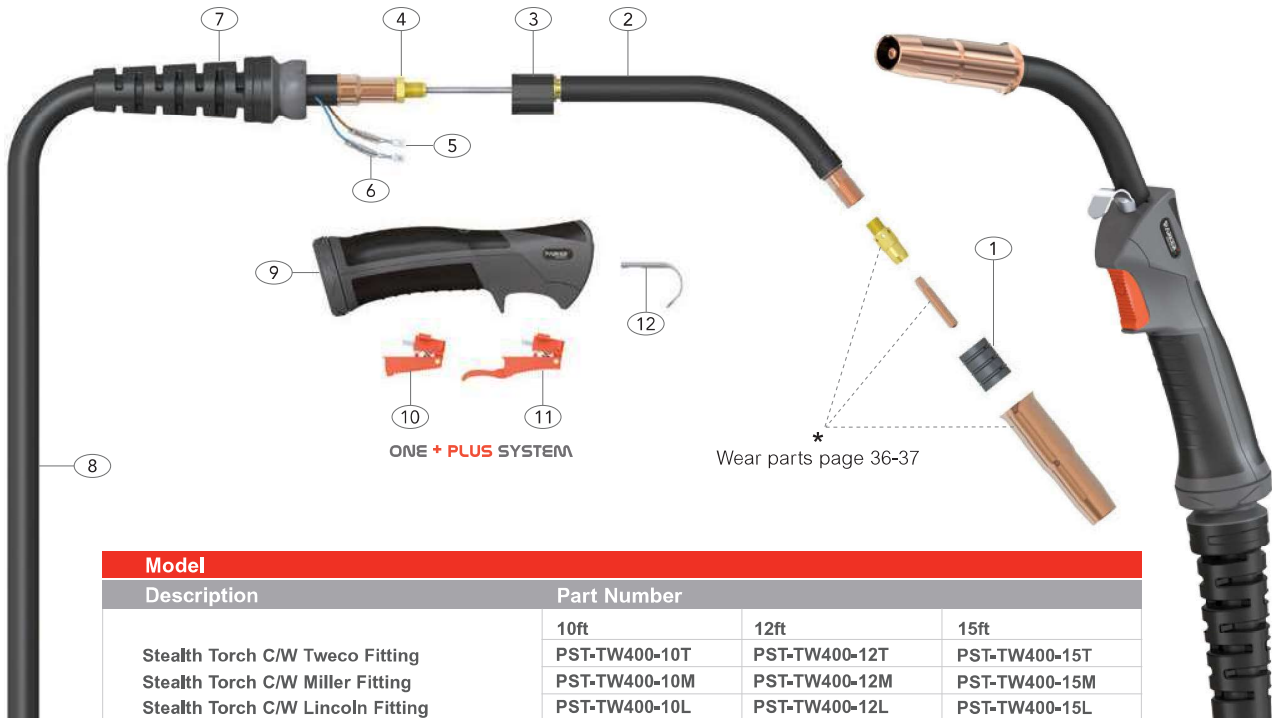

Model			
Description	Part Number		
	10ft	12ft	15ft
Stealth Torch C/W Tweco Fitting	PST-TW400-10T	PST-TW400-12T	PST-TW400-15T
Stealth Torch C/W Miller Fitting	PST-TW400-10M	PST-TW400-12M	PST-TW400-15M
Stealth Torch C/W Lincoln Fitting	PST-TW400-10L	PST-TW400-12L	PST-TW400-15L

Spare parts			
Part Number	Description	Part Number	Description
1	P34A Adjustable Nozzle Insulator	18	PECEM1575/2 Hybrid Plug Body TWC 180-400
2	PLS-TW4 Swan Neck Assembly	19	PBL1541 Gun Plug Screw
3	PG1515 Ergo Handle Location Body	20	PECEL1575/1 Tweco 1-4 Power Pin
4	PB1505 Lock Nut	21	PECEL1575K Lincoln Connector Kit Complete
5	PB1521 Cable Terminal	22	PECEM1575K Miller Connector Kit Complete
6	PB1521-C Cable Terminal Cover		
7	PG8016 Handle Cable Support		
8	PSTH400-10E Cable Assembly X 10ft		
	PSTH400-12E Cable Assembly X 12ft		
	PSTH400-15E Cable Assembly X 15ft		
9	SGB2514 Ergo Handle Kit C/W Lock Nut		
10	DGB2516 Standard Trigger Assembly		
11	DGB2516L Extended Trigger Assembly		
12	PB2517 Hanger Hook		
13	PA3541 Cable Support		
14	PXL1542 Lock Nut		
15	PB1522 Cable Terminal Male		
16	SCSP1-1 Gun Plug Housing Screw		
17	SC2578H/L Gun Plug Housing		

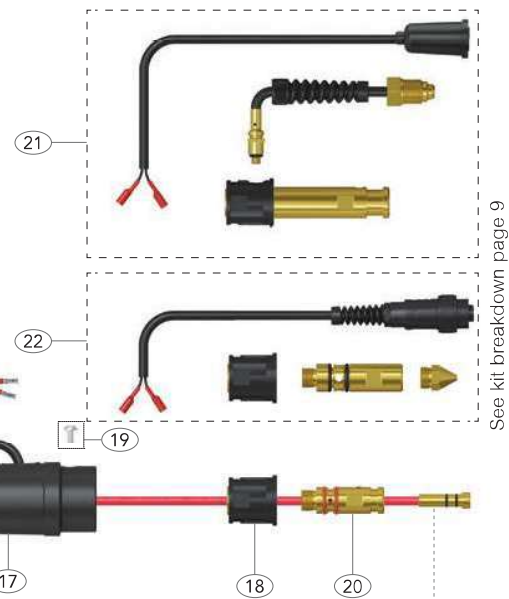

See kit breakdown page 9

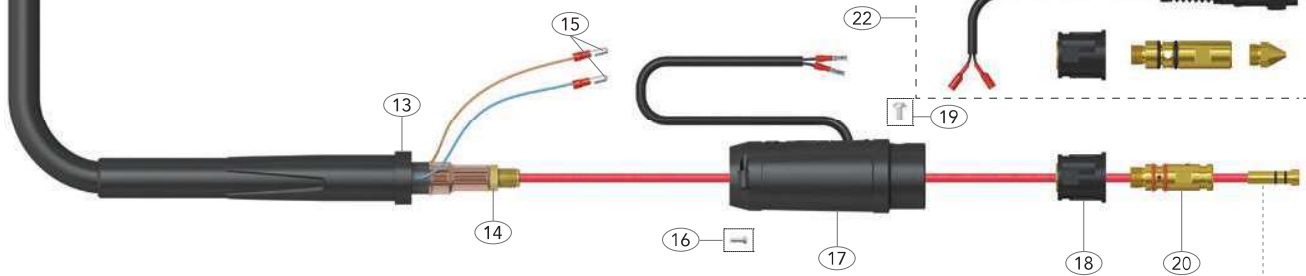

* Wear parts page 38